

Corn heads

GERINGHOFF

Mais Star* | Mais Star* SC | Mais Star* Horizon



English

Head of the class - no matter the crop

Drive system & gathering chains

Good reasons to choose Geringhoff

Always ready & perfectly tensioned

The gathering chains are tensioned automatically. As the chain tensioner is tuned to the patented sprocket, the driveline is protected from blockages caused by debris and gearbox failures are avoided.

Geringhoff is the only manufacturer to offer automatic tensioning for the gathering chains.



Great performance requires an exceptional drive system. Our headers are driven by a reliable crown wheel gearbox. We deliberately designed a system that does without chains and belts to ensure smooth harvesting. Geringhoff uses Centaflex® couplings to connect the row units. The dampers on the couplings significantly reduce vibration and shock loads on the

gearbox that drives the row unit, thereby multiplying its reliability. An excellent service life, low maintenance, great flexibility, and compatibility with different combines are truly good reasons for choosing Geringhoff.





The transverse auger

Always in the perfect position

The auger height is adjusted **infinitely variably** to support massive throughputs and to respond fast and easily to varying harvest conditions. The large-diameter auger feeds the crop very gently without compromising on performance.

- ▶ Infinitely variable auger height adjustment
- ▶ Gentle crop treatment
- ▶ Maximum throughputs
- ▶ Smooth and steady operation
- ▶ Quick and easy adjustment to current harvest conditions



The trough

Form follows function

The trough is engineered to combine form and function in perfect harmony. Its special design suggests resistance-free crop feeds and maximum intake levels, ensuring a gentle and smooth flow into the threshing system even in high-density crops. The large number of aluminum components makes this header a lightweight contender.

- Low weight
- Consistent feeds to the threshing system
- Gentle crop treatment
- For maximum throughputs



Row unit hoods & divider tips

The body scores on many details

Numerous elements of the body are made of plastic to make it light in weight, maintenance-free and highly resistant to wear and ensure dependable operation even after many hours of harvesting. There is no need to replace the hoods. The extremely lightweight and reliable plastic body offers superior gliding properties as it smoothly divides the crop rows.

Its well-designed form proves its perfect functionality in down crops as the lodged plants slide up the smooth panels and contours, aided by the long and flat tips.

Hinged divider tips and wide skids offer optimum ground control. They are particularly low-maintenance and run no risk of bulldozing.

Fine tuned to all conditions

The tips offer tool-less adjustment from a hand wheel on their undersides for fine-tuning to requirements.

Geringhoff is the only manufacturer to offer such infinitely-variable tip adjustment. This system is standard specification on your Geringhoff corn header.



The smart body design gives easy access to the picking system and the hoods and the tips are unlocked without tools and raised and opened conveniently with the help of gas struts. The front skids can be replaced individually. All of this makes cleaning and maintenance a breeze.

- ▶ Extremely lightweight, sturdy body
- ▶ Corrosion free / wear resistant paint finish
- ▶ Superior slip properties for easier harvesting
- ▶ No bulldozing, no downtimes
- ▶ Maximum yields from down corn
- ▶ Tool-less removal and installation of tips and hoods



Hydraulic deck plate adjustment

Safe & reliable

The deck plates are adjusted hydraulically and steplessly via a double-acting and fail-safe hydraulic system, which ensures mechanical smoothness and great operational reliability. This maintenance free system is resistant to any form of contamination, corrosion and exposure to extremely cold temperatures.

- ▶ Infinitely variable deck plate adjustment
- ▶ Low maintenance
- ▶ Eliminates jams and blockages
- ▶ No risk of corrosion
- ▶ Suitable for use in extremely cold climates
- ▶ Standard equipment



The operator terminal

Full control

The Geringhoff control terminal offers intuitive operation and displays all key settings and parameters of the header. It reads out the current speed, shows the current position of the deck plates and adjusts them at the push of a button.

Folding headers are automatically folded by pressing a key on the terminal.

- ▶ Supplied with the machine as standard equipment
- ▶ Fast check of all settings and parameters
- ▶ Easy monitoring of deck plate adjustment
- ▶ Quick access to all key functions

The Mais Star* concept

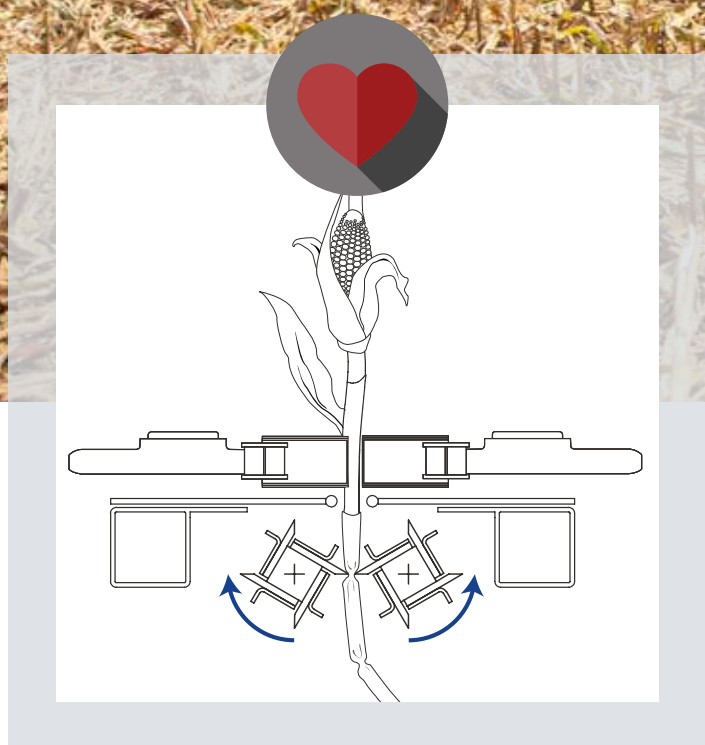

Stalk and stubble management

Work results

Two counter-rotating snapping rolls, each fitted with four knife bars, aggressively pull the corn stalks downward in a controlled motion.

This enables the deck plates to strip the corn cob off the plant. The unchopped corn stover remains in the field, protecting the soil from erosion.

- ▶ Eliminates the stubble pass
- ▶ Minimizes stover destruction
- ▶ Low power requirements for the picker drive
- ▶ Effectively protects the soil from erosion and water evaporation
- ▶ Prevents fields from drying up



Model	Version	No. of rows	Row width	Transport width	Approx weight
MS 400	Rigid	4 rows	from 50 cm / 18"	3.20 m	1,500 kg
MS 500	Rigid	5 rows	from 50 cm / 18"	3.95 m	2,200 kg
MS 600	Rigid	6 rows	from 50 cm / 18"	4.70 m	1,910 kg
MS 600 F	Folding	6 rows	from 50 cm / 18"	3,00 m	2,300 kg
MS 800	Rigid	8 rows	from 50 cm / 18"	6.20 m	2,500 kg
MS 800 F	Folding	8 rows	from 50 cm / 18"	3.30 m	2,900 kg
MS 1200	Rigid	12 rows	from 50 cm / 18"	9.20 m	3,600 kg
MS 1200 F	Folding	12 rows	from 50 cm / 18"	4.80 m	4,000 kg
MS 1600 B	Rigid	16 rows	from 50 cm / 18"	12.20 m	5,200 kg
MS 1600 FB	Folding	16 rows	from 50 cm / 18"	6.40 m	5,700 kg
MS 1800 B	Rigid	18 rows	from 50 cm / 18"	13.90 m	5,640 kg
MS 1800 FB	Folding	18 rows	from 50 cm / 18"	6.80 m ¹⁾	5,550 kg
MS 2400 B	Rigid	24 rows	from 50 cm / 18"	12.70 m	6,200 kg
MS 2400 FB	Folding	24 Row	from 50 cm / 18"	6.60 m ²⁾	6,880 kg

¹⁾ For 22" row spacings | ²⁾ For 20" row spacings



Please note

The specified transport width and weight values are approximate and for reference only. The values in the chart are based on a standard-spec header offering a row width of 75cm / 30". Please contact us for information on other models and exact specifications.

Gathering system (1)

- ▶ Enclosed twin bearings at the front for particularly safe operation
- ▶ Carbide auger flights and hardened scrapers ensure long service life and superior reliability

Snapping rolls (2)

- ▶ Replaceable carbide knives are coated for increased service life
- ▶ Additional counter-edges minimize the presence of stover in the threshing system for higher acreages and ground speeds

Scrapers (3)

- ▶ Additional scrapers prevent the row unit from wrapping with crop in difficult conditions
- ▶ Adjustable system for a long service life

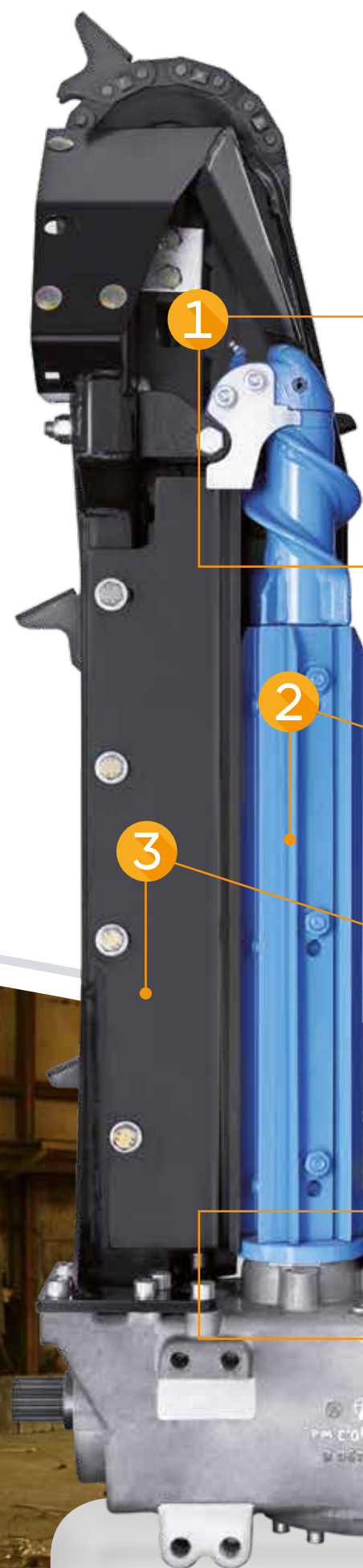



Drive train (4)

- ▶ The splined drive shaft between the gearbox and the rotor is push-fit for easy attachment and removal
- ▶ Labyrinth seals protect the system from debris and dirt

Row unit gearbox (5)

- ▶ Lightweight, aluminum-magnesium alloy gearbox housing
- ▶ Integrated and maintenance-free dog coupling protects the snapping rolls from overload



The Mais Star* SC concept

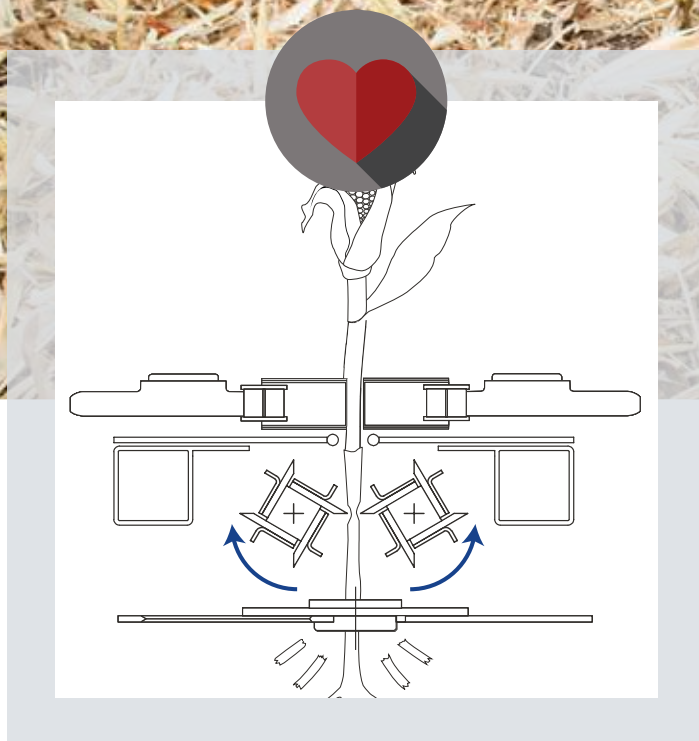

Stalk and stubble management

Work results

The Mais Star* SC concept relies on the proven Mais Star* design: Two counter-rotating snapping rolls, each fitted with four knife bars, aggressively pull the corn stalks downward in a controlled motion. The integral horizontal chopper **located in the center of the row unit**, shreds the gathered corn stalks at minimum of input power for fast decomposition.

- ▶ Short and uniform stubble
- ▶ Excellent distribution of chops
- ▶ Maximum chopping quality to reduce the formation of Fusarium fungi and to avoid pest survival
- ▶ Virtually eliminates the need for mulching or follow-up chopping



Model	Version	No. of rows	Row width	Transport width	Approx. weight
MSSC 400	Rigid	4 rows	from 50 cm / 18"	3.20 m	1,800 kg
MSSC 500	Rigid	5 rows	from 50 cm / 18"	3.95 m	2,000 kg
MSSC 600	Rigid	6 rows	from 50 cm / 18"	4.70 m	2,200 kg
MSSC 600 F	Folding	6 rows	from 50 cm / 18"	3.00 m	2,600 kg
MSSC 800 B	Rigid	8 rows	from 50 cm / 18"	6.20 m	2,900 kg
MSSC 800 FB	Folding	8 rows	from 50 cm / 18"	3.30 m	3,400 kg
MSSC 1200 B	Rigid	12 rows	from 50 cm / 18"	9.20 m	4,400 kg
MSSC 1200 FB	Folding	12 rows	from 50 cm / 18"	4.80 m	4,800 kg

¹⁾ For 22" row spacings | ²⁾ For 20" row spacings



Please note

The specified transport width and weight values are approximate and for reference only. The values in the chart are based on a standard-spec header offering a row width of 75cm / 30". Please contact us for information on other models and exact specifications.

Gathering system (1)

- ▶ Enclosed twin bearings at the front for particularly safe operation
- ▶ Carbide auger flights and hardened scrapers ensure long service life and superior reliability

Snapping rolls (2)

- ▶ Replaceable carbide knives are coated for increased service life
- ▶ Additional counter-edges minimize the presence of stover in the threshing system, enabling greater levels of productivity and higher ground speeds

Scrapers (3)

- ▶ Additional scrapers prevent the row unit from wrapping with crop in difficult conditions
- ▶ Adjustable system for a long service life

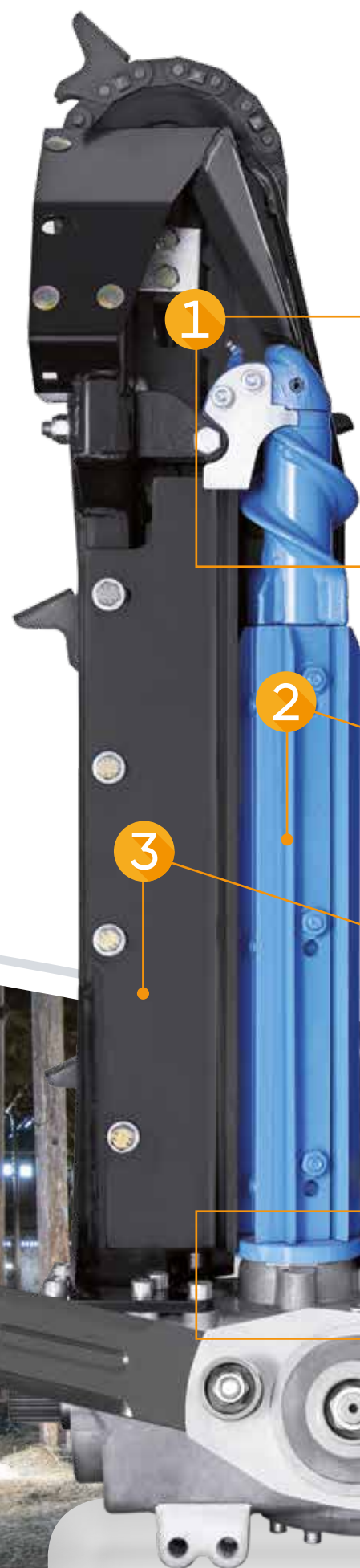

Drive train (4)

- ▶ The splined drive shaft between the gearbox and the rotor is push-fit for easy attachment and removal
- ▶ Labyrinth seals protect the system from debris and dirt

Row unit gearbox (5)

- ▶ Lightweight, aluminum-magnesium alloy gearbox housing
- ▶ Integrated and maintenance-free dog coupling protects the snapping rolls from overload

Horizontal chopper system (6)

- ▶ Separate chopper gearbox made of an aluminum-magnesium alloy using Zerol®-splined bevel gears for maximum smoothness and perfect torque transmission
- ▶ Slip clutch integrated in the knife carrier protects the row unit from overload



The Mais Star* Horizon concept

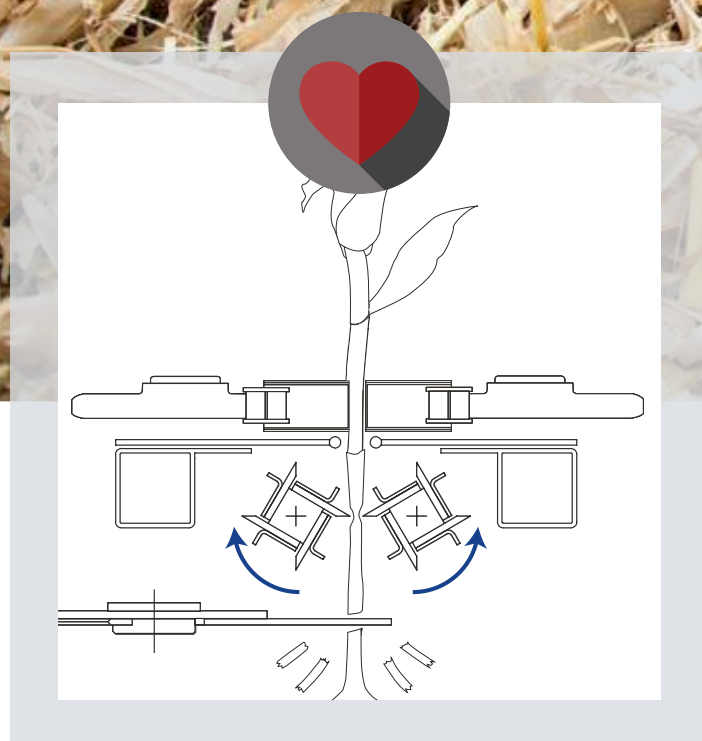

Stalk and stubble management

Work results

The Mais Star* Horizon system builds on the proven Mais Star* concept: Two counter-rotating snapping rolls, each fitted with four knife bars, aggressively pull the corn stalks downward in a controlled motion. The integral horizontal chopper **located next to the row unit**, shreds the gathered corn stalks with a minimum of input power for fast decomposition.

- ▶ Short and uniform stubble
- ▶ Excellent distribution of chops
- ▶ Maximum chopping quality to reduce disease and pest infestation
- ▶ Virtually eliminates the need for mulching or follow-up chopping



Model	Version	No. of rows	Row width	Transport width	Approx. weight
MSH 400	Rigid	4 rows	from 50 cm / 18"	3.20 m	1,800 kg
MSH 500	Rigid	5 rows	from 50 cm / 18"	3.95 m	2,000 kg
MSH 600	Rigid	6 rows	from 50 cm / 18"	4.70 m	2,200 kg
MSH 600 F	Folding	6 rows	from 50 cm / 18"	3.00 m	2,600 kg
MSH 800 B	Rigid	8 rows	from 50 cm / 18"	6.20 m	2,900 kg
MSH 800 FB	Folding	8 rows	from 50 cm / 18"	3.30 m	3,400 kg
MSH 1200 B	Rigid	12 rows	from 50 cm / 18"	9.20 m	4,400 kg
MSH 1200 FB	Folding	12 rows	from 50 cm / 18"	4.80 m	4,800 kg

¹⁾ For 22" row spacings | ²⁾ For 20" row spacings



Please note

The specified transport width and weight values are approximate and for reference only. The values in the chart are based on a standard-spec header offering a row width of 75cm / 30". Please contact us for information on other models and exact specifications.

Gathering system (1)

- ▶ Enclosed twin bearings at the front for particularly safe operation
- ▶ Carbide auger flights and hardened scrapers ensure long service life and superior reliability

Snapping rolls (2)

- ▶ Replaceable carbide knives are coated for increased service life
- ▶ Additional counter-edges minimize the presence of stover in the threshing system, enabling greater levels of productivity and higher ground speeds

Scrapers (3)

- ▶ Additional scrapers prevent the row unit from wrapping with crop in difficult conditions
- ▶ Adjustable system for a long service life

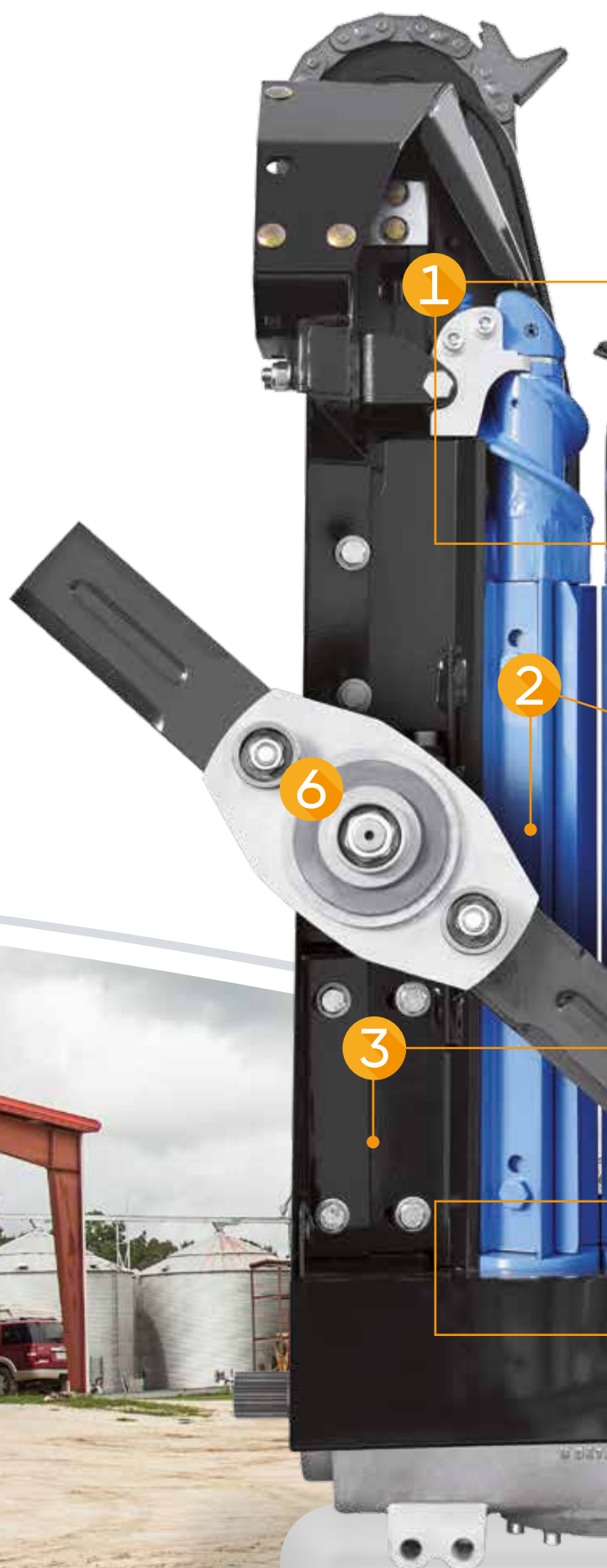



Drive train (4)

- ▶ The splined drive shaft between the gearbox and the rotor is push-fit for easy attachment and removal
- ▶ Labyrinth seals protect the system from debris and dirt

Row unit gearbox (5)

- ▶ Lightweight, aluminum-magnesium alloy gearbox housing
- ▶ Integrated and maintenance-free dog coupling protects the snapping rolls from overload

Horizontal chopper system (6)

- ▶ Separate chopper gearbox made of an aluminum-magnesium alloy using Zerol®-splined bevel gears for maximum smoothness and perfect torque transmission
- ▶ Slip clutch integrated in the knife carrier protects the row unit from overload



The Geringhoff folding system

Fast travel between fields

Positive connections, systematic folding

- ▶ All drivelines are coupled automatically to ensure all header sections are frictionally connected
- ▶ Maintenance-free, conical dog couplings ensure a proper connection
- ▶ Reliable operation as the hoods lock and open hydraulically

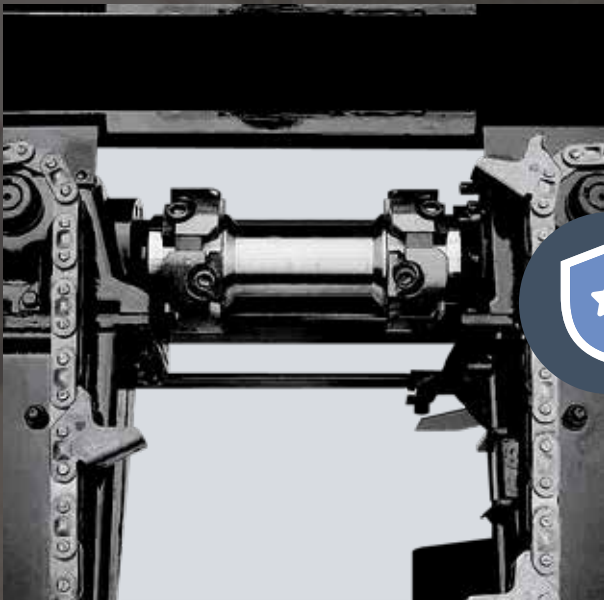

There is no doubt that a folded header makes road transport much easier and safer. What's more, it saves you money, as change-overs are faster so you can be more productive. Changing from transport to work position takes just a few minutes after pressing a button. Your Geringhoff corn header has an automatic and self-adjusting drive coupler as

standard, which allows it to fully tap into the combine's leveling feature. No need to couple the transmission shaft manually.



Anything goes



1 Active sunflower kit

- ▶ Optional specification in sunflowers
- ▶ Field characteristics determine which system is recommendable



2 Passive sunflower kit

- ▶ Optional specification in sunflowers
- ▶ Field characteristics determine which system is recommendable



3 Manual speed selector

- ▶ 4-speed selector
- ▶ Perfectly matches individual speeds to corn and sunflower crops



4 Down corn auger

- ▶ Ideal for harvesting down crops
- ▶ Hydraulic drive system



5 Ground sensor system

- ▶ Automatic ground sensors for ground contouring
- ▶ Available with a self-leveling system (depending on combine model)



6 Stalk breakers

- ▶ Height-adjustable, spring-floated skids break the stubble
- ▶ Protects your tires
- ▶ Ensures minimum ground clearance

Geringhoff headers in individual combine livery

Order the paint finish that matches your combine



We are here to assist you.

Head of the class – no matter the crop



Geringhoff has been operating in the farm equipment industry since 1880. To this day, the company is a family-run business that is steered by the fifth generation. Over this extensive time, the image of our company has been shaped by many outstanding figures. The beginnings of Geringhoff date back to a small blacksmith shop and farm equipment trading company. Today,

this company has grown into a modern and international manufacturer of specialist harvesting technology which caters for a wide range of different crops that are farmed around the world. As we strive to ease your workload and boost your productivity, we are focused on one single goal: to build head of the class headers – no matter the crop.



The logo for Geringhoff, featuring the word "GERINGHOFF" in a bold, italicized, sans-serif font. The letter "G" is significantly larger and more stylized than the other letters, which are in a smaller, uniform font.

Carl Geringhoff

Vertriebsgesellschaft mbH & Co. KG

Porschestraße 8

D-59227 Ahlen

Germany

Phone Number: +49 (0) 2382 9814 - 0

E-mail: info@geringhoff.de

www.geringhoff.de